

*RAILKING*  
**READY-TO-RUN™**  
THE COMPLETE SOLUTION

[www.railking.com](http://www.railking.com)

# Alaska F40PH Passenger Set

Operation Manual

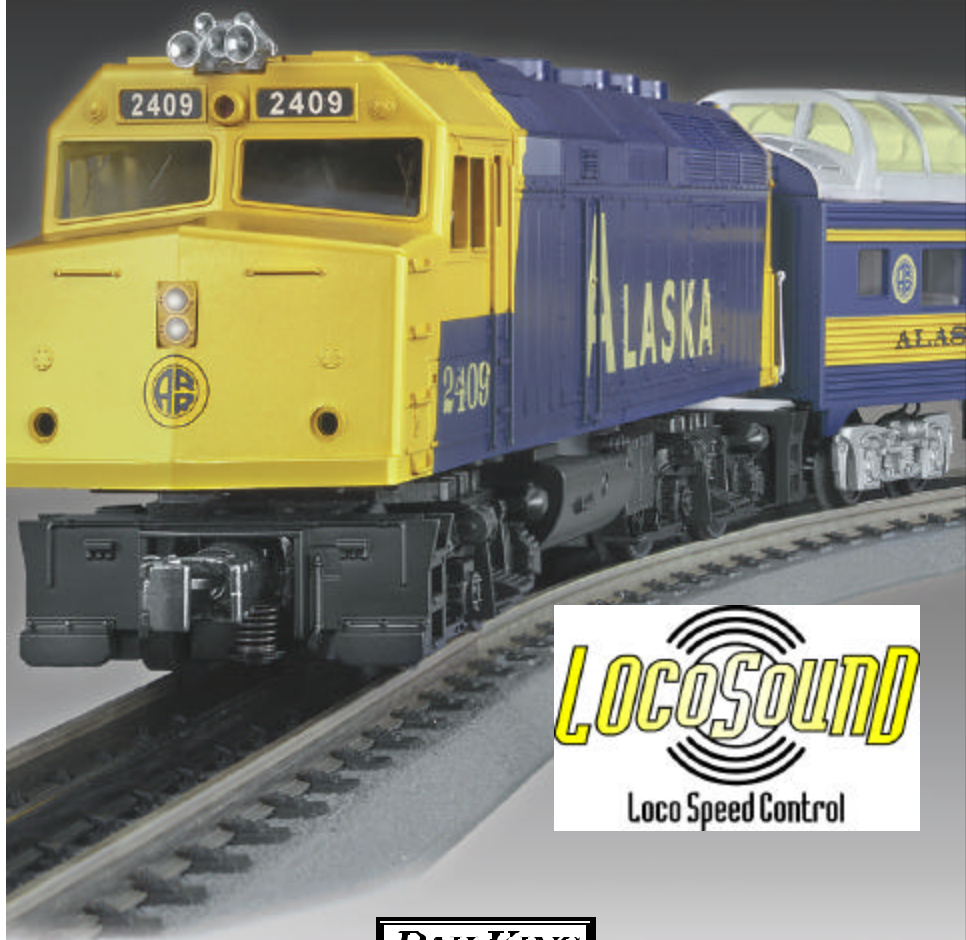

**LocoSound**  
Loco Speed Control

**RAILKING**  
By MTH Electric Trains

Thank you for purchasing this RailKing product.  
**PLEASE READ BEFORE USE AND SAVE**

# Table of Contents

<b>Set Up Checklist</b> .....	<b>3</b>
<b>Getting Started</b> .....	<b>4</b>
Assembling Real Trax.....	4
Plugging in the Transformer.....	4
Lubricating the Engine.....	5
Coupling the Engine and Cars.....	5
Remote Control.....	5
<b>Basic Operation</b> .....	<b>6</b>
Operation Buttons.....	6
Speed Control.....	7
Direction Lock.....	7
Proto-Cast and Proto-Dispatch.....	7
Manual Volume Control.....	8
<b>Maintenance</b> .....	<b>10</b>
Care of Remote Control.....	10
Lubrication and Greasing Instructions.....	10
Cleaning the Wheels, Tires and Track.....	11
Locomotive Light Bulb Replacement.....	12
Passenger Car Light Bulb Replacement.....	12
<b>RailWare Interactive CDROM</b> .....	<b>15</b>
<b>Troubleshooting</b> .....	<b>16</b>
<b>Compatibility</b> .....	<b>17</b>
<b>Transformer Compatibility Chart</b> .....	<b>17</b>
<b>Exploded View Parts</b> .....	<b>18</b>
<b>Service and Warranty Information</b>	

## CAUTION: ELECTRICALLY OPERATED PRODUCT:

Not recommended for children under 10 years of age. M.T.H. recommends adult supervision with children ages 10-16. As with all electric products, precautions should be observed during handling and use to reduce the risk of electric shock.

**WARNING:** When using electrical products, basic safety precautions should be observed, including the following: Read this manual thoroughly before using this device.

- M.T.H. recommends that all users and persons supervising use examine the hobby transformer and other electronic equipment periodically for conditions that may result in the risk of fire, electric shock, or injury to persons, such as damaged or the primary cord, plug blades, housing, output jacks or other parts. In the event such condition exist, the train set should not be used until properly repaired.
- Do not operate your layout unattended. Obstructed accessories or stalled trains may overheat, resulting in damage to your layout.
- This train set is intended for indoor use. Do not use if water is present. Serious injury or fatality may result.
- Do not operate the hobby transformer with damaged cord, plug, switches, buttons or case.
- The transformer was designed to operate on regular US household current (120 volt, 50-60 Hertz). Do not connect to any other source of power.
- To avoid the risk of electrical shock, do not disassemble the transformer unit. There are no user-serviceable parts inside. If the unit is damaged contact M.T.H. Service for instructions.
- The transformer is equipped with an internal circuit protector. If the circuit protector trips, unplug the power cord from the electrical wall outlet, check your layout for any short circuits. The circuit breaker will reset automatically when the short is removed from the circuit.
- Unplug the transformer from the electrical wall outlet when not in use.
- Do not use this transformer for other than its intended purpose.

## Transformer Ratings:

Input: 120VAC, 60Hz Only, Output: 21VAC, 3.75A 78VA

# Set Up Checklist

- Assemble RealTrax®
- Connect the transformer
- Lubricate the engine
- Place the engine and cars on the track and couple them together
- Position remote lock-on lens
- Apply power to run as described in the Basic Operation section of these instructions.

## Set Includes



Diesel Engine with Loco-Sound™



8-Pieces  
O-31 Curve RealTrax



Lock-On



Track Clips

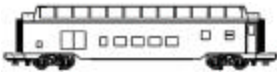

3 Vista Dome Cars



Remote Control



CD-Rom



Video

## Tools Needed



Pliers



Scissors

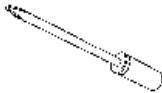

Philips Screwdriver



Cotton Swab or Rag



RailKing Maintenance Kit  
Light Household Oil and Bearing Grease

## Optional Equipment



Microphone w/1/8" Plug



1/8" Male to Male Plug



Cassette Player

**You can obtain replacement parts and replacement instructions from the M.T.H. Parts Department**

e-mail: [parts@nth-railking.com](mailto:parts@nth-railking.com)

phone: 410-381-2580

mail: 7020 Columbia Gateway Drive, Columbia MD 21046-1532

# Getting Started

## Assembling RealTrax®

The quick connectors and built-in road bed allow you to set up RealTrax anywhere, including carpeted surfaces.

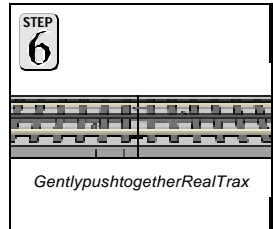
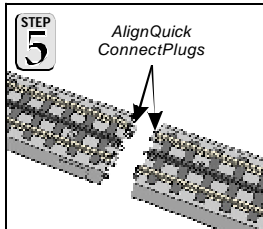
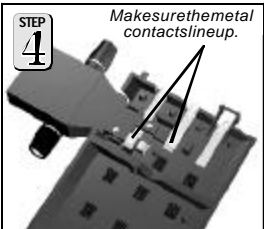
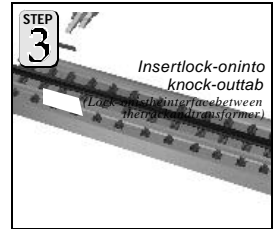
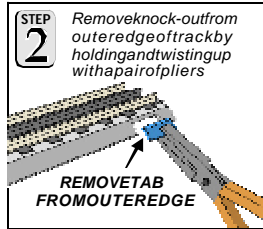
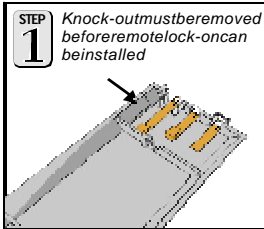

### Connecting TrackClips

If you prefer not to screw your track to the table for a permanent layout, use the enclosed track clips on adjoining curved RealTrax sections to secure them in place.

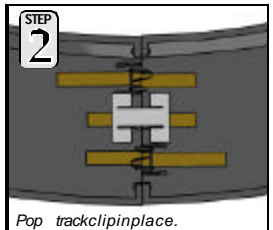
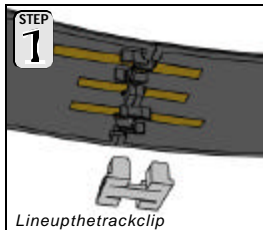

### Connecting the Transformer

The 75-watt power supply included with this set provides an easy-to-use, safe power source for AC-powered trains and accessories.

- Plug the wire from the transformer into the remote lock-on's center port, then plug the transformer into the wall outlet.
- Unplug when not in use.

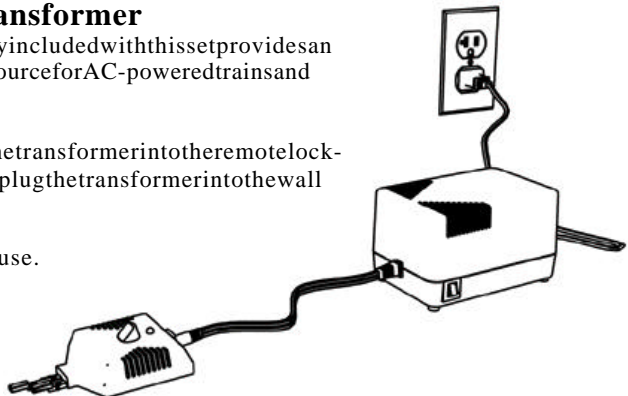

## Lubricating and Greasing the Engine

Lubricate all exposed moving parts before operating using a multi-purpose, plastic-compatible oil (available with M.T.H.'s Maintenance Kit, sold separately) or a light household oil. Follow the lubrication points.

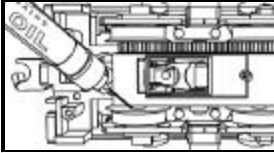

Lubricate Axles

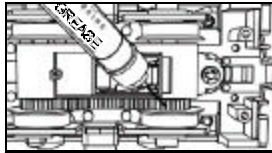

Grease Gears

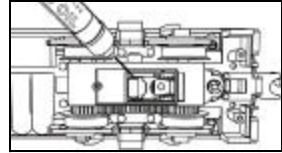

Lubricate Pick-Up Rollers  
(Do Not Lubricate the Flat Part of Pick-Up Rollers)

## Coupling the Engine and Cars

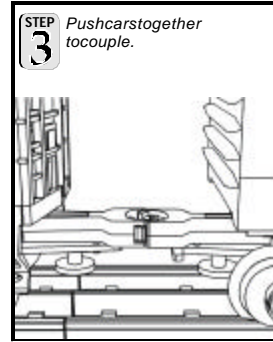
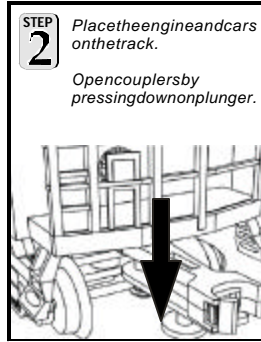
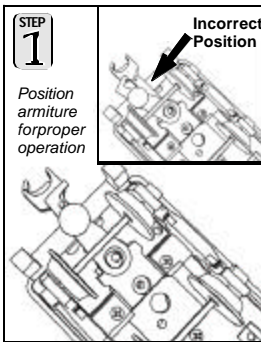

## Remote Control

The remote and lock-on are redesigned for use with moderate power supplies such as the one included with this set. It is compatible with virtually any manufacturer's engines.

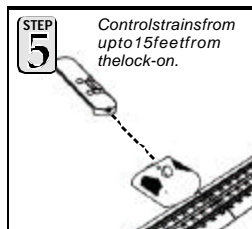
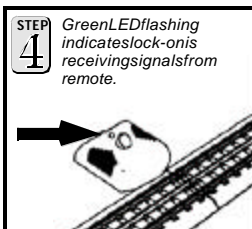
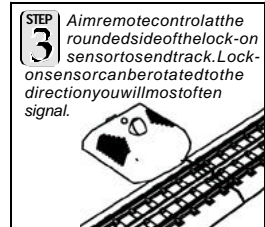
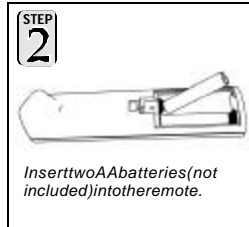
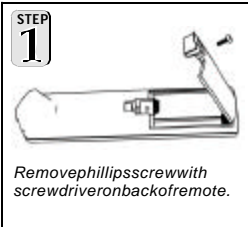

**Note:** The RailKing® Remote Control and Remote Lock-on will not operate engines equipped with pre-1997 versions of Proto-Sound® or with Proto-One,™ Proto-Plus,™ Proto-Deluxe,™ aftermarket systems.

# Basic Operation

**ThrottleUp** ThrottleupthepowertoyourtrackbypressingthetopendoftheThrottle ControlRockerSwitchfirmlyforabout5seconds,untiltheengine'sheadlightand lightedcarsburnbright. Thenputtheengineintomotionbyfirmlypressingthe Directionbutton(holditforapproximately1second)onyourremoteonce. Iftheengine doesnotbegintomoveassoonasyoufirmlypresstheDirectionbutton,youmaynot have sentenoughvoltage tothetracktomakethetrainmove. Pressthethrottleupfor a fewmoresecondsuntilthetrainbeginstomove.

Toincreaseordecreasetrackvoltage,andthereforetrainspeed,pressthethrottlecontrol rockerswitch. Pressingthetopendofthethrottlewillincreasevoltageandspeed. Pressingthebottomendofthethrottlewilldecreasevoltageandspeed.

Theenginewillmaintainthespeedyousetafteryoureleasethethrottleuntilyoupressit againtochangethevoltageandspeed.

**Bell** - Tosoundthebell,firmly pressandreleasetheBell button.Toturnthebelloff, pressandreleasetheBellbutton again. Thebellwillcontinueto ringfromthetimeyouturniton untilyoupressandreleasethe buttonagaintoturnitoff.

**EmergencyStop** Pressthe EmergencyStopbuttonandall trainsonthetrackcontrolledby theremotewillstopuntilyou reapplyvoltage. Thisisaneasy waytoshutdownyourtrainsat theendofasessionortostop suddenlyifthetrain'spath becomesobstructed.

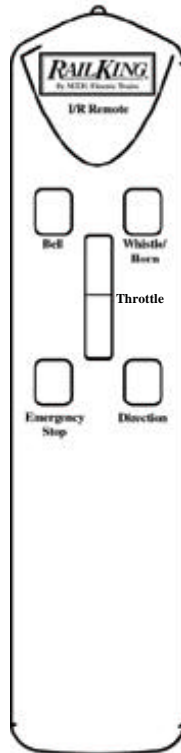

**Horn/Whistle** - Tosoundthehorn, firmlypresstheHorn/Whistle button.Thehornwillsoundforas longasyoucontinuetodepressthe button. Itwillstopwhenyou releasethobutton.

**Direction** Yourtrainis programmedtostartinneutral. Thetrainwillalwayscycle neutral-forward-neutral-reverse witheachpressandreleaseofthe directionbutton. Theengineis programmedtorestartinneutral eachtimethetrackvoltageis turnedofffor25secondsormore.

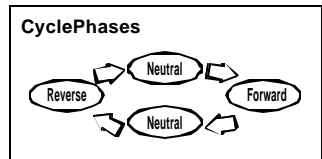

## Speed Control

M.T.H. engines equipped with Loco-Sound have speed control capabilities that allow the engine to maintain a constant speed up and down grades and around curves, much like an automobile cruise control. You can add or drop cars on the run, and the engine will maintain the speed you set.

The engine is programmed to start with the speed control feature reactivated, you can opt to turn it off. This means the engine's speed will fall as it labors up a hill and increase as it travels downward. It is also affected by the addition or releasing of cars while on the run. Because the engine will run more slowly at a given throttle voltage when speed control is on than when it is off, you should adjust the throttle to a lower power level for operation with speed control off to avoid high-speed derailments.

**To turn speed control on and off**, put the engine in neutral, then quickly tap the transformer's Horn button one time then quickly tap the Bell button two times, allowing approximately 1/2 second to lapse between each quick button press. Repeat the 1 horn, 2 bells code to return to the other condition. **You will want to do this during the initial neutral upon start-up if you ever couple this engine to another engine that is not equipped with speed control to avoid derailment and damaging the motors in either engine.** Each time you shut down the engine completely, it will automatically turn speed control on.

Timing Chart				
Press Horn Short & Firm	1/2 Sec. Pause	Press Bell Short & Firm	1/2 Sec. Pause	Press Bell Short & Firm
Total Time Lapse: 1 1/2 Seconds				



Place Engine into Neutral



=

Speed Control Repeat to Return to Normal Condition

## Direction Lock

You can lock your engine into a direction (forward, neutral, or reverse) so that it will not change directions. To do this, put the engine into the direction you want or into neutral, to lock it into neutral, run it at a very slow crawl (as slowly as it will move without halting), and quickly but firmly tap the Horn button once followed by three quick taps of the Bell button, allowing approximately 1/2 second to lapse between each quick button press. The engine will not change direction (including going into neutral) until you repeat the 1 horn, 3 bells code to return the engine to its normal condition, even if the engine is kept without power for extended periods of time.

Place Engine into Desired Direction



=

Direction Lock Repeat to Return to Normal Condition

## Proto-Cast and Proto-Dispatch:

When used with the remote lock-on included in this set, Loco-Sound-equipped engines gain Proto-Cast™ and Proto-Dispatch™ features.

**Proto-Cast:** Allows you to play audio recording through your engine's speakers. You must supply the audio source (a small portable CD/tape player is sufficient) and a male-to-male minicable (1/8" plug, like that used for the headset with a portable CD/tape player) to connect your audio source to the remote lock-on.



**How to Use Proto-Cast**

- Plug the mini-cable *first* into your audio source (usually into the headphone jack)
- Plug Cable into the "Audio" port on the right side of the remote lock-on.
- Adjust the volume. If engine sounds keep breaking through the recorded sounds, increase the volume on the audio source.



**Proto-Dispatch:** This feature allows you to broadcast your own voice through your engine's speakers. You must supply the microphone and a minicable (1/8" plug, like that used for the headset with a portable CD/tape player) to connect your microphone to the remote lock-on.



**How to Use Proto-Dispatch**

- Mini-cable attached to the microphone must be an 1/8" plug.
- Plug the "Mic" into the proto-dispatch port on the left side of the remote lock-on and speak into the microphone.



When these features are in use, the locomotive's own sounds (engine sounds and bells, whistles, and horns) will be muted so that only the sounds you broadcast will be heard. Because these two features are voice activated, there will be a several second delay after you stop speaking into the microphone or turn off the audio source before the engine sounds resume. To stop using the feature and return to normal operation, unplug the cable from the lock-on jack.

If using parallel tracks with multiple Loco-Sound-equipped engines, Proto-Cast and Proto-Dispatch transmissions from one track may be picked up by the other nearby engines.



If you experience popping and interference when using Proto-Castor Proto-Dispatch, try cleaning the track with denatured alcohol as described in the "Cleaning the Wheels, Tires and Track" section of this booklet.

**Note:** M.T.H. does not recommend using Proto-Cast and Proto-Dispatch at the same time.

## Manual Volume Control

To adjust the volume of all sounds made by this engine, turn the master volume control knob located under the engine clockwise to increase the volume and counter-clockwise to decrease the volume.

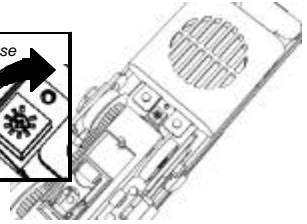
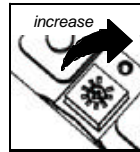

# Maintenance

## Care of the Remote Control

To ensure trouble-free operation:

- Do not drop the remote. It can damage the delicate electronics inside.
- Remove batteries before storing for extended periods.
- Any attempt by anyone other than an authorized M.T.H. repair person to open and repair the handheld transmitter or lock-on may result in damage and the loss of warranty protection.
- If your train responds inconsistently, replace old batteries with fresh ones. Do not mix old and new batteries.

## Lubrication and Greasing Instructions

The engines should be oiled and greased in order to run properly.

Regularly lubricate all axles and linkage components and pick-up rollers to prevent squeaking. Use light household oil, such as that found in M.T.H.'s maintenance kit. Do not overoil. Use only a drop or two on each pivot point.

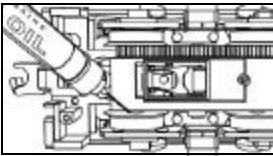

Lubricate Axles

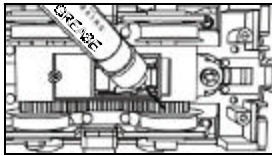

Grease Gears

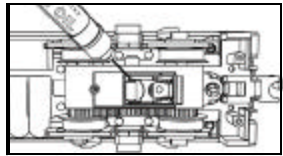

Lubricate Pick-Up Rollers  
(Do Not Lubeth the Flat Part of Pick-Up Rollers)

The locomotive's internal gearing was greased at the factory. Grease engine every 50 hours of use or every year. Use lithium based grease and follow the greasing instructions.

**STEP 1** Remove the six Phillip screws from the chassis then lift the body away from the chassis.

**STEP 2** Remove the truck blocks from the chassis by unscrewing the large phillips motor mounts screw on the bottom of each truck block.

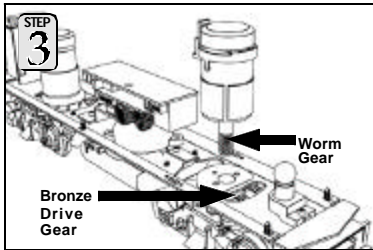

- Once the motor mount screw has been removed, pull the motor away from the truck block and lightly coat the motor worm gear and bronze drive gear (in the truck block) with grease.
- Reassemble the truck and motor, being careful not to pinch the pickup and ground wires between the truck block and motor mount.
- Repeat the procedure if engine has more than one motor.
- Reassemble the chassis and body, being careful that the wires are not caught between the body and chassis, as this can lead to a short that may damage the electronics beyond repair.

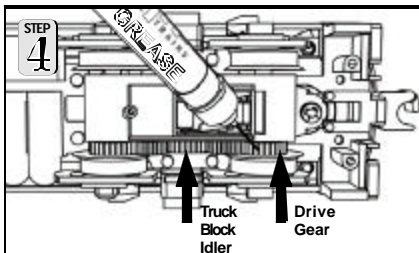

- Lubricate the outside truck block idler and drive gears with grease occasionally.

## Cleaning the Wheels, Tires and Track

Periodically check the locomotive wheels and pickups for dirt and buildup, which can cause poor electrical contact and traction and prematurely wear out the neoprene traction tires. Wheels and tires can be cleaned using denatured (not rubbing) alcohol applied with a cotton swab.



To clean the track, use Rail King Track Cleaning Fluid and a clean rag or denatured (not rubbing) alcohol. Unplug the transformer and wipe the rails of the track, turning the rag frequently to ensure that you are using a clean cloth on the rails. Because the manufacturing process leaves a coating on Real Trax center rail, you should clean the rails after the first 30 minutes of use (you may notice an electrical smell during initial use as the coating wears off; this is normal). Thereafter, keep an eye on the track and clean it when it gets dirty to ensure good electrical contact and to lengthen the life of the tires.

## Traction Tire Replacement Instructions

Your locomotive is equipped with two neoprene rubber traction tires on the rear set of flanged drivers. While these tires are extremely durable, you may need to replace them at some point.

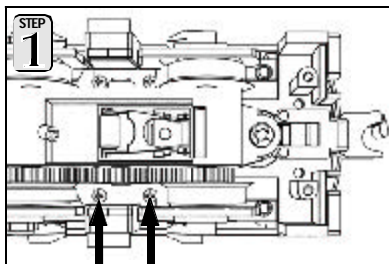

- Remove two screws from below truck side.
- Remove the truck sides from the truck block.
- Make sure the old tire has been completely removed from the groove in the drive wheel, using a razor blade or small flathead screwdriver to pry away any remains.
- Clean the groove using a cotton swab and denatured alcohol.

**STEP 2**

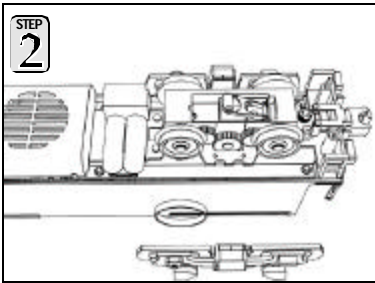

- Slip the new tire onto the wheel. You may find it useful to use two small flat head screw drivers to stretch the tire over the wheel.
- If you twist the tire while stretching it over the wheel, you will need to remove and reinstall the tire. Otherwise your engine will wobble while operating.
- Make sure the tire is fully seated inside the groove. Use a razor blade to trim away any excess tire that doesn't seat itself inside the groove properly.
- Reassemble the truck sides to the truck blocks.

## Locomotive Light Bulb Replacement

Follow the cab removal instructions found in the Greasing Instructions section of this booklet (page 10).

- Rotate the headlight bulb counter-clockwise to remove.

You can obtain replacement bulbs directly from the M. T. H. Parts Department.

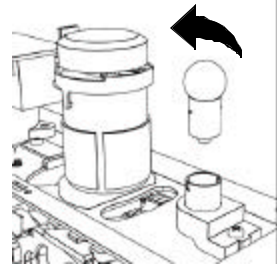

## Passenger Car Light Bulb Replacement

To replace the interior light bulbs follow these instructions and see the diagrams

**Note:** Different sized screws are used in this assembly. It is very important that you remember where each screw came from and replace it correctly. To help you with the different sized screws, please refer to the screw chart.

You can obtain replacement bulbs and screws directly from the M. T. H. Parts Department.

**STEP 1** Turn the car over, padding it carefully to avoid scratches.

Remove the small Phillips screw that is holding the ground wire in place from each truck (two screws total). Release one wire from under the screw, and pull the other wire from its connection to the pick-up roller assembly of each truck.

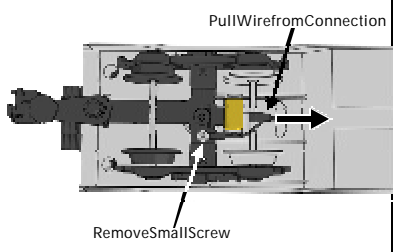

Pull Wire from Connection

Remove Small Screw

**STEP 2** Remove the four recessed mounting screws located at the corners of the car.

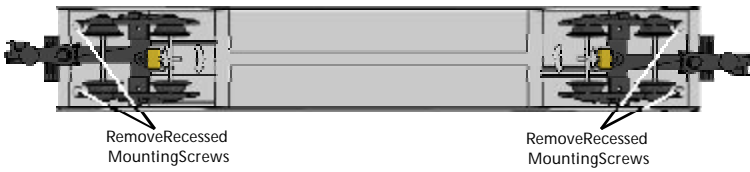

Remove Recessed Mounting Screws

Remove Recessed Mounting Screws

**STEP 3**

Turn the trucks so that you can reach the interior-mounting screw located under each truck (two screws total), and remove them.

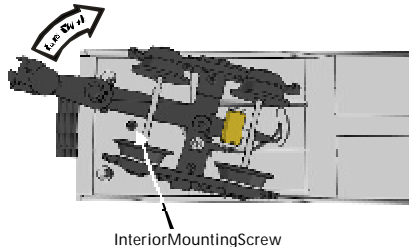

**STEP 4**

Pop the roof of the car by holding each end of the car and twisting them in the opposite direction, then gently remove the roof and interior from the chassis, pulling the loosened wires completely free from the chassis as you lift.

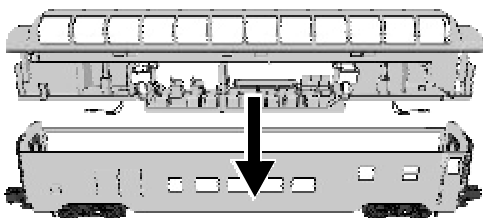

**STEP 5**

Turn the interior over and remove the four screws from the bottom to separate the two levels of the interior. Replace the two lower light bulbs by tilting their housing and popping the moulike Christmas tree lights.

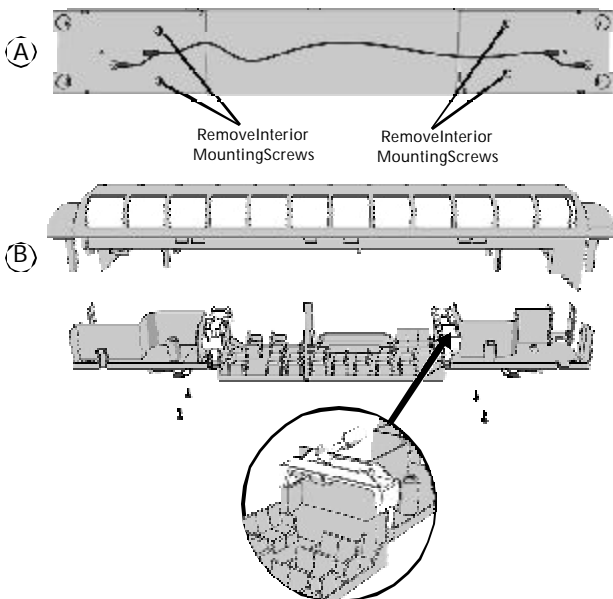

**STEP 6**

•Remove the four screws on the bottom of the upper interior to remove the roof. Pull it off and replace the four bulbs by popping them out like Christmas tree lights.

Reassemble the car in the reverse order, making sure that the interior is placed inside the body the right way. If it is backwards, a post will show through a window when looking at the side view. (See figure 7)

Take care that wires are not pinched upon reassembly and that when you connect them to the trucks, they do not rub against a wheel, as pinched or rubbed wires can cause shorts.

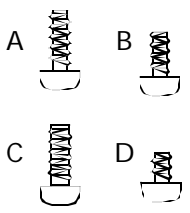
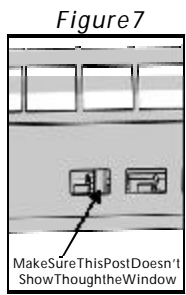
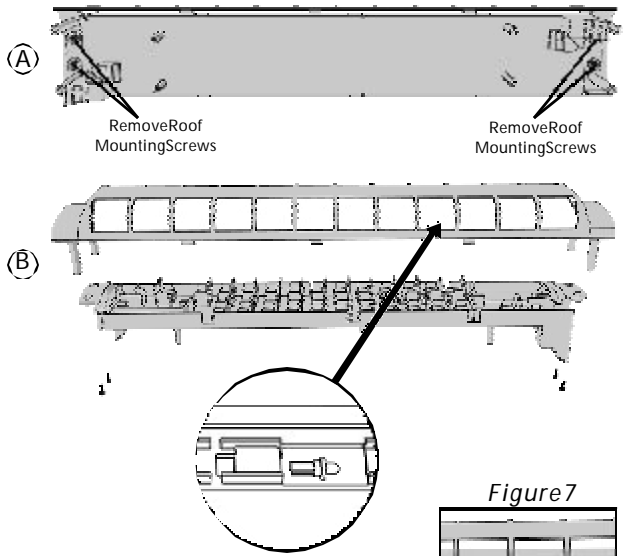

Screw Chart			
	Connecting Areas	Size	# of Screws
A	Upper and Lower interior	M2.6x8.0mm	4
A	Upper interior & Roof	M2.6x8.0mm	4
B	Lower interior & Body	M2.6x6.0mm	2
C	Body & Roof	M3.0x8.0mm	4
D	Ground Wire	M2.6x4.0mm	2

# Quick-Start Video

The included VHS Quick-Start video demonstrates the start-up and basic operation of this set as well as other information about model railroading. You may find it helpful to view the video before operating this set.

# RailWare Interactive CD ROM

M.T.H. provides a free RailWare CD ROM in each Ready-To-Run set. It is full of helpful information on M.T.H. product history, track planning software, a dealer finder, and information and video clips on Loco-Sound and Proto-Sound 2.0. Follow the directions below to use the CD ROM.

Minimum System Requirements: Pentium 100, 16MB RAM, Windows 95 or later, CD ROM drive, Sound Card, display properties set to greater than 256 colors. The CD will not work on a Mac OS unless you run Virtual PC.

# Running RR-Track Software

You may run the RR-Track software directly off of the CD ROM or you may install the software to your hard drive.

1. On the Desktop, click on the icon that says My Computer.
2. Find your CD ROM drive.
3. With the M.T.H. CD ROM in the drive, double click on the icon for the CD ROM drive.
4. Find the folder on the CD ROM entitled INSTALLATION.
5. Choose the folder inside entitled RRTRAXSETUP.
6. Run the file in that folder called SETUP.EXE and follow the directions it provides.

The program may ask you for a registration code. If it does type in "M.T.H." and it will run.

Additional track libraries can be obtained directly from RR-Track. See their website for more information [www.rtrack.com](http://www.rtrack.com).

# Installing Adobe Acrobat Software

To read some of the electronic documents included on the CD ROM, you will need to install the Adobe Acrobat Reader® if it is not already on your computer. To install the software:

1. On the Desktop, click on the icon that says My Computer.
2. Find your CD ROM drive.
3. With the MTH CD ROM in the drive, double click on the icon for the CD ROM drive.
4. Find the folder on the CD ROM entitled INSTALLATION.
5. Choose the folder inside entitled ACROBATREADER.

\*If you are running Windows 95, 98 or NT choose the folder 32BIT. Run the file AR32E301.EXE and follow the directions it provides.

If you have problems you cannot resolve by using these directions, contact [custserv@nth-railking.com](mailto:custserv@nth-railking.com) or call 410-381-2580 for further help.

# Troubleshooting Loco-Sound™ Problems

Although Loco-Sound has been designed and engineered for ease of use, you may have some questions during initial operation. The following table should answer most questions. If your problem cannot be resolved with this table, contact M.T.H. for assistance (e-mail: [service@mth-railking.com](mailto:service@mth-railking.com), telephone: 410-381-2580; fax: 410-423-0009; mail: 7020 Columbia Gateway Drive, Columbia MD 21046-1532).

<b>Starting Up</b>	<b>Remedy</b>
When I first turn the power on, the engine will not begin to run.	This is normal behavior. To prevent accidental high-speed start-ups, Loco-Sound is programmed to start up in neutral any time track power has been turned off for several seconds. See the "Basic Operation" section for more details.
The engine will not start after I press the Direction button.	You may not be sending enough power to the track to power the engine. Press the throttle up for a few more seconds to increase track power.
<b>Horn</b>	<b>Remedy</b>
I can't get the horn to blow when I press the horn button.	You may be pressing the button too quickly. Try pressing the horn button more slowly, taking approximately one full second to fully depress the button.
<b>Bell</b>	<b>Remedy</b>
I can't get the bell to ring when I press the bell button.	You may be pressing the button too quickly. Try pressing the bell button more slowly, taking approximately one full second to fully depress the button.
<b>Lock-out</b>	<b>Remedy</b>
I can't get the engine to run after power up the transformer. It's still with the engine sounds running.	The engine may be locked into the neutral position. Follow the procedure in the "Lock into a Direction" section to <b>unlock the engine's direction</b> .
The engine won't lock into forward, neutral, or reverse.	Engine speed must be below 10 scale mph (approx. 10 volts or less in conventional mode).
<b>Volume</b>	<b>Remedy</b>
The sounds seem distorted, especially when the Horn or Bell is activated.	Loco-Sound volume is set too high. Turn the volume control knob on the bottom of the chassis counter-clockwise to reduce the volume.
No sound.	Volume is set too low, adjust volume control knob on the bottom of the chassis clockwise to increase the volume or check connector to speaker.
<b>Proto-Cast and-Dispatch</b>	<b>Remedy</b>
When I try to play music or my voice through my engine's speakers, there is popping and interference.	Clean the track with denatured alcohol, as described in the "Cleaning the Wheels, Tires, and Track" section of this book.
My Proto-Cast sounds play too quietly or unclearly.	Unplug the cable between the audio source and the remote lock-on. Re-plug it into the audio source first, then into the lock-on, pushing firmly to make sure it is fully installed.
When I try to play Proto-Cast, the engine's sounds keep breaking in on my recording.	Your recording may be playing too quietly to trigger the engine to stop playing its own sound set. Turn up the volume of the audio source you are using.
When I run two Loco-Sound engines on tracks near each other, the Proto-Cast and Dispatch sounds play from both engines, not just from the one connected to the audio source or microphone.	This is normal behavior. Because Loco-Sound uses radio waves to transmit the sound to the engine, other Loco-Sound engines in the same range will also pick up the sound. Try moving one of the sets.



# Compatibility

While this Ready-To-Run set is equipped with everything you need to operate it, the design allows flexibility. The train will operate on any traditional O-31 or larger O Gauge track system, including the RealTrax<sup>®</sup> included with this set or traditional tubular track. It is also compatible with most standard AC transformers, including the hobby transformer packaged with your set.

## Transformer Compatibility and Wiring Chart

Note that many of the operational commands described in these instructions require a bell button, so if you are using a transformer other than the one included in this set and your transformer does not have its own bell button, you should consider adding one to get the full benefit of the system.

Transformer Model	Center Rail	Outside Rail	Min/Max. Voltage	Power Rating	Transformer Type
MTHZ-500	Red Terminal	Black Terminal	0-18v	50-Watt	Electronic
MTHZ-750	Red Terminal	Black Terminal	0-21v	75-Watt	Electronic
MTHZ-4000	Red Terminal	Black Terminal	0-22v	390-Watt	Electronic
Lionel1032	U	A	5-16v	90-Watt	Standard
Lionel1032M	U	A	5-16v	90-Watt	Standard
Lionel1033	U	A	5-16v	90-Watt	Standard
Lionel1043	U	A	5-16v	90-Watt	Standard
Lionel1043M	U	A	5-16v	90-Watt	Standard
Lionel1044	U	A	5-16v	90-Watt	Standard
Lionel1053	U	A	8-17v	60-Watt	Standard
Lionel1063	U	A	8-17v	60-Watt	Standard
All-Trol	Left Terminal	Right Terminal	0-24v	300-Watt	Electronic
Dallee Hostler	Left Terminal	Right Terminal			Electronic
Lionel LW	A	U	8-18v	75-Watt	Standard
Lionel KW	A or B	U	6-20v	190-Watt	Standard
Lionel MW	Outside Track Terminal	Inside Track Terminal	5-16v	50V.A.	Electronic
Lionel RS-1	Red Terminal	Black Terminal	0-18v	50V.A.	Electronic
Lionel RW	U	A	9-19v	110-Watt	Standard
Lionel SW	U	A	Unknown	130-Watt	Standard
Lionel TW	U	A	8-18v	175-Watt	Standard
Lionel ZW	A, B, C or D	U	8-20v	275-Watt	Standard
Lionel Post-War Celebration Series ZW	A, B, C or D	Common	0-20v	135/190 Watt	Electronic

# F40-PH Diesel Locomotive Engine Parts

Name and Number	Part #
1.) Lens(clear)(portal)	FA-0000009
2.) Lens(clear)(10.7mmlong) ( headlight/back-up light)(3.2x6.0mmtaperedshaft)	FA-0000007
3.) Dynamicbrakevent(blue) (7.2x11.7mm)(Alaska)(#2409)	FC-2200228
4.) Shell(blue,yellow) ( Alaska)(#2409)	FC-2200225
5.) Airhorns(nickel)(5chime)	FC-2200080
6.) Numberboard(#2409) ( Alaska)(whitenumbersonblackbackground)	FG-2200035
7.) Lens(clear) (ditchlight)(3.2x5.0x9.2mm)	FA-0000005
8.) Lens(clear) (marker)(3.2x5.0x10.7mm)	FA-0000072
9.) Lens(clear)(warninglights)	FA-0000008
10.) Windows ( clear)(front&sides)	FA-2200007
11.) Chassis(black) (forProto-Sound2.0®&Loco-Sound™w/batteryjack)	DD-2200003
12.) Socket(black) (plastic)(7.0mmthickbayonetbase)	CH-0000037
13.) Screw (M3x6.0mm)(roundhead)	IA-0000016
14.) Bulb(clear)(6v)(smallglobe) (bayonetbase)(headlight/cabinterior)	CG-0000024
15.) Screw (M3x14.0mm)(roundhead)(w/lockwasher)	IA-0000012
16.) Screw(yellowZinc) (M2.5x6.0mm)(roundhead)(w/lockwasher)	IA-0000089
17.) Motormount(black)	BI-0000005
18.) Motor(RS-365SH) (8.0x17.0mmwormgearw/11.0mmlongthreads) (9.0x30.0mmblackflywheel)	BE-0000046
19.) Motor(RS-365SH) (8.0x17.0mmwormgearw/11.0mmlongthreads) (9.0x30.0mmwhiteflywheelw/blackstripes) (w/tachboardmount)	BE-0000072
20.) Rubberband	BI-4500004
21.) Tachboard	AG-0000033
22.) Board ( Loco-Sound™)	AE-0000002
23.) Screw (4/40x6.0mm)(roundhead)	IA-0000003
24.) Screw (M3x8.0mm)(roundhead)	IA-0000035
25.) Volumepot(small) (bluepotmountedongreenPCboard)	BI-0000040

26.) Spacer(black) (plastic)(3.0x6.0x4.0mm)	ID-0000071
27.) Speakercone(black) (plastic)(11.0x38.0mm)(shavedon2sides)	BF-0000014
28.) Bracket(Aluminum) ( forLoco-Sound™board)(32.0x35.4mmbase) (32.0x76.0mm)(17.0mmstep)	IH-0000208
29.) Insulator(clear) (13.0x16.0x0.1mm)(singlehole)	ID-0000024
30.) Insulatorwasher(white) (3.0x6.0x3.0mm)	ID-0000025
31.) Wirenut(yellow)	BI-4500003
32.) Screw (M3x3.0mm)(roundhead)	IA-0000296
33.) Handrail(nickel)(rear)	FC-2240005
34.) Screw (4/40x6.0mm)(flathead)	IA-0000038
35.) Pilot(black)(front/rear) (2mountingholes&splitinthemiddle) ( Alaska)(#2409)	DG-2250029
36.) Screw (M3x16.0mm)(washerhead)(self-drilling)	IA-0000025
37.) Bracket(black)(speaker)	IH-0000011
38.) Speaker (Cuistack)(GF0501,8ohms,0.25watt)	BF-0000015
39.) Speakerringseal(black) (43.8x49.8x3.0mm)(foam)	IB-0000009
40.) Fuel tank (black) ( Alaska)(#2409)	FC-2200081
41.) Truckside(black) (trucksidemountfrombottom)	DB-2060008
42.) Truck ( powered )(2axle) (2threadedscrewholesformountingpilot) (trucksidemountfrombottom)	DA-2000013
43.) Insulator(black) (plastic)(pick-up)(top)(square)	BD-0000047
44.) Screw(nickel) (M3x6.0mm)(roundhead)	IA-0000015
45.) Tractiontire	DE-0000018
46.) T-bar ( black)(plastic)	IG-0000001
47.) Coupler (mechanical)(51.5mmlong)	DD-0000039
48.) Armature(45.0mmlong)	DD-0000040
49.) Spring(nickel) (6.5x9.0mm)(0.4mmthickwire)	IE-0000009
50.) Washer(black)(plastic) (4.6x8.5x0.5mm)(cupshapedforspringtofitin)	ID-0000060
51.) E-clip(3.0x8.0x0.5mm)	IF-0000002

52.) Nut(nickel) (2.5x5.0x10.0mm)	IC-0000005
53.) Insulator(black)(plastic) (pick-up)(bottom)(flatw/rect.box)(18.0x30.0mm)	BD-0000039
54.) Pick-up (8.0x11.0mmroller)(28.0mmlong)	BD-0000025
NS.) Wireharness (10pinblackplasticmaleplug)	BC-2200010
NS.) Wireharness (7pinblackplasticmaleplug)	BC-2200008
NS.) Wireharness (5pinblackplasticmaleplug)	BC-2200009

# F40-PH Diesel Locomotive Engine Parts

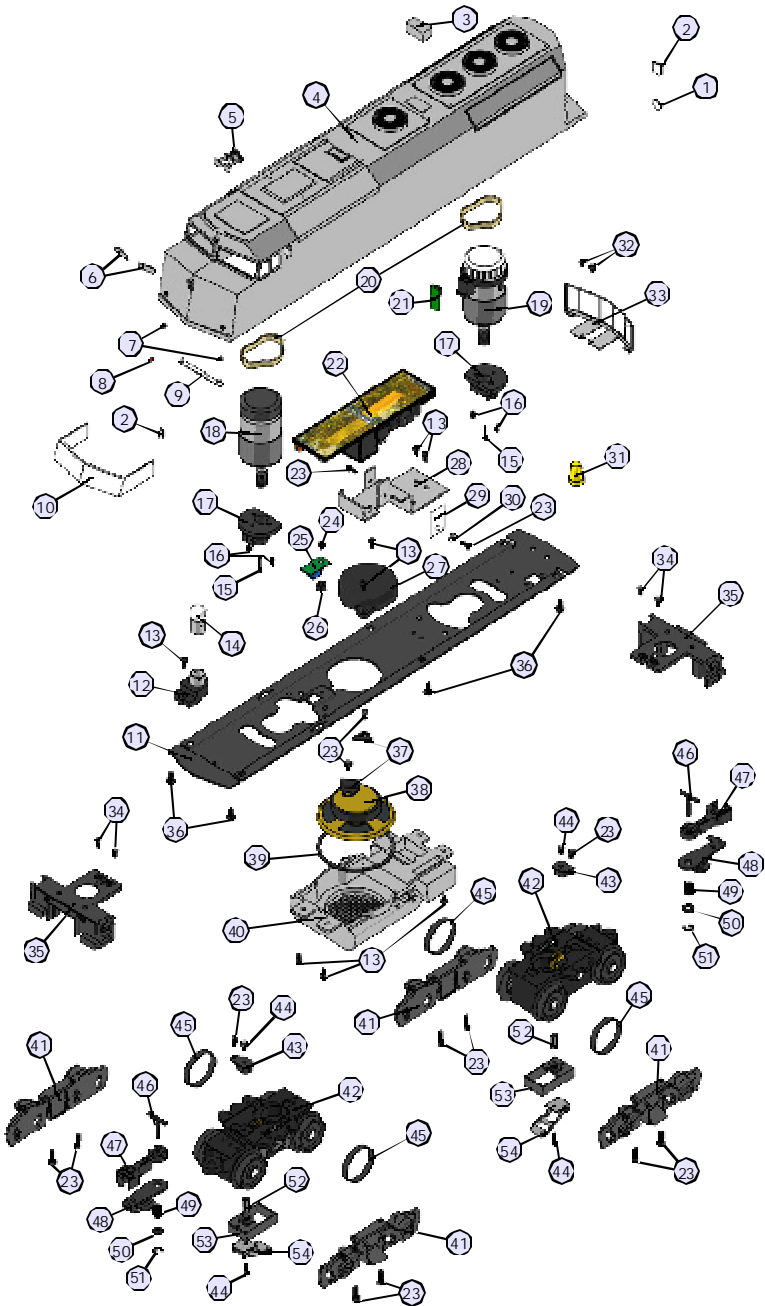





# Service & Warranty Information

## How to Get Service Under the Terms of the Limited One-Year Warranty

For warranty repair, follow the instructions below to obtain warranty service.

- First, e-mail, write, call or fax an Authorized M.T.H. Service Center in your area or M.T.H. Electric Trains to obtain Repair Authorization. You can find the list of Authorized Service Centers on the M.T.H. website, [www.mth-railking.com](http://www.mth-railking.com). Otherwise, contact M.T.H. (e-mail: [service@mth-railking.com](mailto:service@mth-railking.com); 7020 Columbia Gateway Drive, Columbia, MD 21046; tel: 410-381-2580; fax: 410-423-0009), stating when the item was purchased and describing the problem. If you contact M.T.H., you will be given a return authorization number to assure that your merchandise will be properly handled upon its receipt.
- **CAUTION:** Make sure the product is packed in its original factory packaging including its foam and plastic wrapping material so as to prevent damage to the merchandise. The shipment must be prepaid and we recommend that it be insured. ***A cover letter including your name, address, daytime phone number, e-mail address (if available), Return Authorization number, a copy of your sales receipt and a full description of the problem must be included to facilitate the repairs. Please include the description regardless of whether you discussed the problem with a service technician when contacting the Service Center M.T.H. for your Return Authorization.***
- Please make sure you have followed the instructions carefully before returning any merchandise for service.

## Limited One-Year Warranty

All M.T.H. products purchased from an Authorized M.T.H. Train Merchant are covered by this warranty.

See our website at [www.mth-railking.com](http://www.mth-railking.com) or call 1-888-640-3700 to identify an Authorized M.T.H. Train Merchant near you.

M.T.H. products are warranted for one year from the date of purchase against defects in material or workmanship, excluding light bulbs, pick-up rollers and traction tires. We will repair or replace (at our option) the defective part without charge for the parts or labor, if the item is returned to an Authorized M.T.H. Service Center or M.T.H. Electric Trains within one year of the original date of purchase. This warranty does not cover damages caused by improper care, handling, or use. Transportation costs incurred by the customer are not covered under this warranty.

Items sent for repair must be accompanied by a return authorization number, a description of the problem, and **acopy of the original sales receipt from an Authorized M.T.H. Train Merchant**, which gives the date of purchase. If you are sending the item to M.T.H., call 410-381-2580, fax 410-423-0009, or e-mail the Service Department at [service@mth-railking.com](mailto:service@mth-railking.com) to obtain a return authorization number. If you are sending this product to an Authorized Service Center, contact that Center for their return authorization.

This warranty gives you specific legal rights, and you may have other rights that vary from state to state.

Service Department  
M.T.H. Electric Trains  
7020 Columbia Gateway Drive  
Columbia, Maryland 21046-1532

