



MTH AUXILIARY TENDER OPERATING INSTRUCTIONS



Thank you for purchasing the MTH Electric Trains GS-4 Auxiliary Water Tender. This die-cast 1:48 scale replica of the water tender makes a perfect compliment for any owner of a 1:48 scale GS-4 steam locomotive and includes the necessary hardware to configure the Proto-Sound® and Proto-Coupler® system found in the MTH GS-4 steam locomotives to operate the water tender's own Proto-Coupler.

PREMIER LINE

Configuring the GS-4 Tender to operate with the GS-4 Auxiliary Water Tender Proto-Coupler® .

For the Auxiliary Water tender's Proto-Coupler to function, it must be electrically connected to your GS-4 Oil Tender. To accomplish this, there is a preinstalled wire harness inside the Oil Tender that will connect the two tenders together electrically.

First start by using a Phillips screwdriver to remove the 6 chassis screws securing the Oil Tender's body to its chassis. Refer to your GS-4 Steam Locomotive instruction manual for their specific location. Upon removing the tender body, identify the wire harness, which should be secured inside the chassis near the Oil Tender's speaker cone. Refer to figure 1. and follow how the wire harness is fed through the hole at the rear of the floor/chassis. Be sure not to bind or twist the harness during this process.

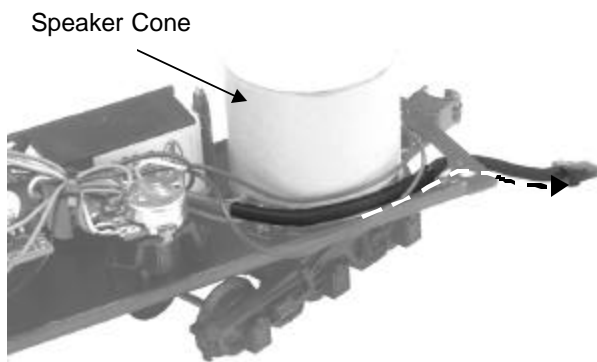

Fig1. Feeding the Wiring Harness Through the Floor of the Oil Tender

Reinstall the tender body with the six securing screws. You may now select protocoupler operation of either tender by the switch selection underneath the GS-4 Oil Tender. Refer to your GS-4 Steam Locomotive instruction manual for specific location of the switch. Proto-Coupler operation is selected by sliding the switch towards the rear of the Oil tender for Auxiliary tender Proto-Coupler operation or forward for Oil tender Proto-Coupler operation. After Proto-Coupler operation selection, connect the wire harness plug from the oil tender to the wire harness connector jack on the Auxiliary tender.

You are now ready to enjoy your new GS-4 Auxiliary Water tender with your GS-4 Steam Locomotive.

OIL & LUBRICATION INSTRUCTIONS

In order for the engine to perform correctly and quietly, it is important that the chassis be lubricated before operation. Lubrication should include all truck block bushings and pickup rollers to prevent them from squeaking. Use light household oil and follow the lubrication points marked "L" in Fig. 2 below.

Periodically, check the locomotive wheels and pickups for dirt buildup as this can significantly affect the engine's ability to perform properly. Dirty track and dirty wheels can cause both poor electrical contact as well as poor traction, especially on elevated track sections.

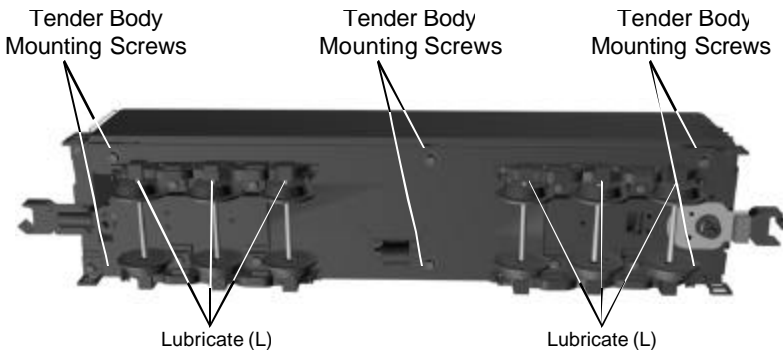

Fig. 2- Lubricating the Chassis and Location of Body Mount Screws

HEADLIGHT REPLACEMENT

The GS-4 Auxiliary Tender contains one grain of wheat 1.5v headlight bulb controlled by the Premier GS-4 tender. The headlight bulb simply plugs into its lamp socket and can be easily removed should the bulb expire. To remove the interior bulb, remove the shell by unscrewing the body mount screws as shown in Figure 2. Once the shell has been removed from the chassis, gently pull the bulb to remove it from the lamp housing. Replacement bulbs are available directly from MTH Electric Trains.

GS-4 Auxiliary Tender

Parts

Name and Number	Part #
1.) Shell (S.P.)(#DLMX 4219)	GA-1100020
2.) Lens (back-up light)	FA-1140002
3.) Ladder	GA-1100021
4.) Handrail	GA-1100022
5.) Ladder	GA-1100023
6.) Grommet	IH-0000010
7.) Bracket	IH-0000110
8.) Screw	IA-0000003
9.) Screw	IA-0000003
10.) Bulb (grain of wheat) (1.5V)(210.0mm long)	CF-0000003
11.) Wire harness (1 male plug)(175.0mm long)	BC-0000032
12.) Screw	IA-0000039
13.) Screw	IA-0000021
14.) Wire strap (metal)	IH-0000012
15.) Wire harness (2 female plugs)(150.0mm long)	BC-0000033
16.) Brakewheel	GA-1100024
17.) Chassis	GB-1100004
18.) Screw	IA-0000050
19.) T-bar	IG-0000001
20.) Proto-coupler	DD-0000004
21.) Washer (insulator)(clear)	ID-0000031
22.) Spring	IE-0000012
23.) Washer	ID-0000022
24.) E-clip	IF-0000002
25.) Screw	IA-0000021
26.) Brake cylinder (black)	GA-1100019
27.) Truck (3 axle)(trailing)	DA-1140001
28.) Truck (3 axle)(front) (same as part # DA-1140001, but w/ hole cut out)	DA-1130006
29.) Screw	IA-0000003
30.) Screw	IA-0000021
31.) Screw	IA-0000021
32.) Wire harness plug PCB	BB-0000020
33.) Coupler (non-operating)	DD-0000024
34.) Ladder assembly	GA-1100025

*Requires Exchange

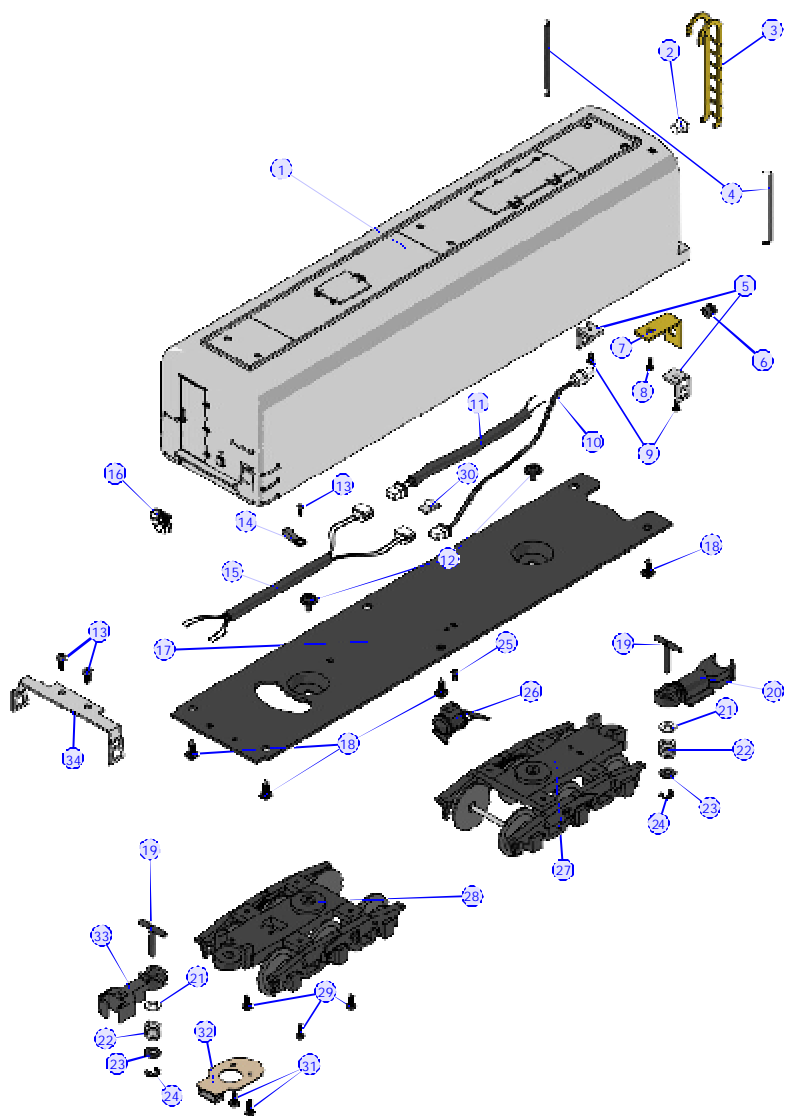

SERVICE & WARRANTY INFORMATION

HOW TO GET SERVICE UNDER THE TERMS OF THE LIMITED ONE YEAR WARRANTY

For warranty repair, do not return your product to the place of purchase. Instead, follow the instructions below to obtain warranty service as our dealer network is not prepared to service the product under the terms of this warranty.

1. First, write, call, email or FAX MTH Electric Trains, 7020 Columbia Gateway Drive, Columbia, MD 21046, 410-381-2580 (FAX No. 410-423-0009), or on the internet at service@mth-railking.com or our web site, www.mthtrains.com, stating which product you have, when it was purchased and what seems to be the problem. You will be given a return authorization number to assure that your merchandise will be properly handled upon its receipt at MTH.

2. CAUTION: Make sure the product is packed in its original factory packaging including its foam and plastic wrapping material so as to prevent damage to the merchandise. The shipment must be prepaid and we recommend that it be insured. *A cover letter, including your name, address, daytime phone number, a copy of your sales receipt, the Return Authorization number and a full description of the problem, must be included to facilitate the repairs. Please include the description regardless of whether or not you discussed the problem with one of our service technicians when contacting MTH for your Return Authorization number.*

3. Please make sure you have followed the instructions carefully before returning any merchandise for service.

LIMITED ONE YEAR WARRANTY

This item is warranted for one year from the date of purchase against defects in material or workmanship. We will repair or replace (at our option) the defective part without charge for parts or labor, if the item is returned to the address below within one year of the original date of purchase. This warranty does not cover items that have been abused or damaged by careless handling. Transportation costs incurred by the customer are not covered under this warranty.

This warranty gives you specific legal rights and you may have other rights which vary from state to state.

ProtoSounds® is a trademark of MTH Electric Trains. DCRU® is a registered copyright of QS Industries, Inc.