



GG-1 ELECTRIC ENGINE W/PROTO-SOUND® 3.0

30-5129-1

30-5132-1

30-5131-1

30-5130-1

30-5115-1

30-5116-1

30-5117-1

30-5118-1

PARTS LIST & EXPLODED VIEW

REV. 07.2015

PARTS LIST: BODY



- | | |
|--|-------------------------------|
| 1.) PANTOGRAPH | BI-3103001001 |
| 2.) INSULATOR | BD-3103002001 |
| 3.) HORN | BF-3103003001 |
| 4.) LENS(SIDE) | CE-3153004001 |
| 5.) WINDOW GLASS C | FA-3103005001 |
| 6.) WINDOW GLASS A | FA-3103006001 |
| 7.) LADDER | FC-3200003 |
| 8.) WINDOW GLASS B | FA-3103008001 |
| 9.) LENS(FRONT) | CE-3133009001 |
| 10.) LENS(HEAD) | CE-3103010001 |
| 11.) SOCKET BASE | IH-3103011001 |
| 12.) BODY(PRR #4820, GREEN 5 STRIPE) | FC-3103012001 |
| BODY(AMTRAK #905) | FC-3103012002 |
| BODY(CONRAIL #4800) | FC-3103012003 |
| BODY(PENN CENTRAL #4848) | FC-3103012004 |
| BODY(PRR #4922, GREEN 1 STRIPE) | FC-3103012005 |
| BODY(PRR #4916, TUSCAN 1 STRIPE) | FC-3103012006 |
| BODY(PRR #4842, GREEN 5 STRIPE) | FC-3103012007 |
| BODY(PRR #4913, TUSCAN 5 STRIPE) | FC-3103012008 |
| 13.) SCREW(M2.0X7.0MM, BLACK) | IA-0000059 |
| 14.) PM MOTOR OUTPUT PULLEY | EG-3103041001 |
| 15.) SCREW(M2.0X6.0MM, BLACK) | IA-0000186 |
| 16.) SERIES PLANETARY GEAR
MOTOR (12GF1215-100) | BE-3103042001 |
| 17.) SCROLL | IH-3103043001 |
| 18.) TRANSMISSION BAND | FC-3103044001 |
| 19.) PANTOGRAPH BOARD | FF-3600000 |
| 20.) MOUNTING BRACKET | IH-3103046001 |
| 21.) MOUNTING STRAP | FI-3103047001 |

EXPLODED VIEW: BODY



RK S/W-1 Diesel Engine

Body parts

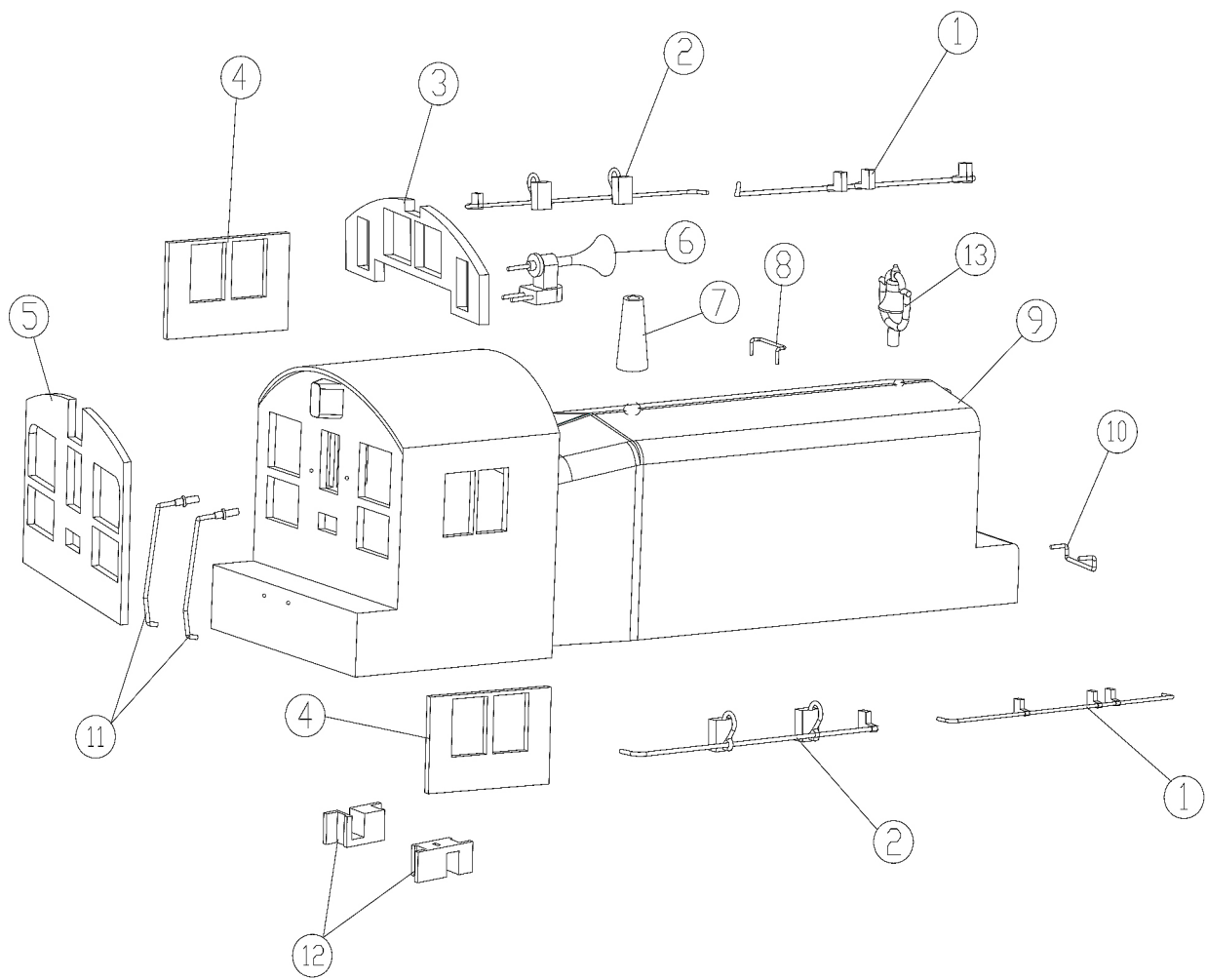

PARTS LIST: CHASSIS



1.) MOTOR (BLACK FLYWHEEL)	BE-3103013001
2.) PS3 DIESEL/ELECTRIC BOARD	AE-1000034
3.) PS3.0 PCB HEATSINK	IH-3103014001
4.) SCREW(M3.0X6.0MM,BLACK)	IA-0000016
5.) TACH BOARD, PS3	AG-0000102
6.) SCREW(M3.0X10.0MM,BLACK)	IA-0000110
7.) MOTOR MOUNT	BI-3103015001
8.) MOTOR (WITH FLYWHEEL STRIPES)	BE-3103016001
9.) SPEAKER	BF-3103017001
10.) SPEAKER COVER	BF-3103018001
11.) SPEAKER BASE	BF-3103019001
12.) RUBBER BAND	BI-4500004
13.) SCREW (M2.5X6.0MM) (BLACK)	IA-0000166
14.) WASHER(A)	ID-3103020001
15.) PS3.0 PCB BRACKET	IH-3103021001
16.) SUPPORT	IH-3103022001
17.) CHASSIS	DH-3103023001
18.) TRUCK COVER	DB-3103024001
19.) PILOT	DG-3103025001
20.) TRUCK BOLSTER	IH-3103026001
21.) WASHER(B)	ID-3103027001
22.) SCREW(M3.0X6.0MM,FLATHEAD)	IA-0000073
23.) PIN	IG-3103028001
24.) WHEEL/AXLE SET, PILOT	DA-3103029001
25.) TRUCK SIDE	DB-3113030001
26.) T-BAR	IG-0000001
27.) PROTO-COUPLER, SHORT	DD-0000033
28.) SPRING(5.5X14.0MM)	IE-0000007
29.) WASHER(5.0X10.0X1.0MM)	ID-0000009
30.) E-CLIP(3.5X8.0X0.5MM)	IF-0000002
31.) TRUCK SIDE FRAME-L	DB-3113036002
32.) TRUCK SIDE FRAME-R	DB-3113037001
33.) GEER BOX SET	EG-3103038001
34.) SCREW(M3.0X14.0MM,W/LOCK WASHER)	IA-0000012
35.) PICK UP ROLLER ASSEMBLY	BD-3200001
36.) SCREW(M3.0X6.0MM,NICKEL)	IA-0000015
37.) INSULATOR, PICK UP	BD-0000027
38.) SWITCH BOARD	AE-3103049001
39.) SWITCH	BB-3103050001
40.) VOLUME POT	BI-0000040
41.) INSULATOR WASHER (BLACK)	ID-0000025

EXPLODED VIEW: CHASSIS



RK S/W-1 Diesel Engine

Chassis parts

