



20-2313-1  
20-2314-1  
20-2315-1  
20-2316-1

# BL-2

## Diesel Engine



GL050602



# BL-2 Diesel Engine

## Shell Parts

NameandNumber	Part#	\$Price PerUnit	NameandNumber	Part #	\$Price PerUnit
1.) Handrail(black)(end) (9.2mmlong)(RockIsland)(#425)(#426)(#428)	FC-2101301	2.00	4.) Numberboard (blackw/frostednumbers)(front)(2.8x8.2x0.3mm) (Boston&Maine)(#1553)	FG-2100388	2.00
Handrail(red)(end) (9.2mmlong)(RockIsland)(#425)(#426)(#428)	FC-2101302	2.00	5.) Numberboard (blackw/frostednumbers)(front)(3.7x9.4x0.3mm) (RockIsland)(#425)	FG-2100389	2.00
Handrail(blue)(end) (9.2mmlong)(C&O)(#80)(#82)(#83) (Bangor&Aroostook)(#50)(#52)(#55)	FC-2101303	2.00	Numberboard (blackw/frostednumbers)(front)(3.7x9.4x0.3mm) (RockIsland)(#426)	FG-2100390	2.00
Handrail(maroon)(end) (9.2mmlong) (Boston&Maine)(#1550)(#1551)(#1553)	FC-2101304	2.00	Numberboard (blackw/frostednumbers)(front)(3.7x9.4x0.3mm) (RockIsland)(#428)	FG-2100391	2.00
Handrail(yellow)(end) (9.2mmlong) (Boston&Maine)(#1550)(#1551)(#1553)	FC-2101305	2.00	Numberboard (blackw/frostednumbers)(front)(3.7x9.4x0.3mm) (C&O)(#80)	FG-2100392	2.00
2.) Handrail(black)(end) (9.2mmlong)(RockIsland)(#425)(#426)(#428)	FC-2101301	2.00	Numberboard (blackw/frostednumbers)(front)(3.7x9.4x0.3mm) (C&O)(#82)	FG-2100393	2.00
Handrail(red)(end) (9.2mmlong)(RockIsland)(#425)(#426)(#428)	FC-2101302	2.00	Numberboard (blackw/frostednumbers)(front)(3.7x9.4x0.3mm) (C&O)(#83)	FG-2100394	2.00
Handrail(blue)(end) (9.2mmlong)(C&O)(#80)(#82)(#83) (Bangor&Aroostook)(#50)(#52)(#55)	FC-2101303	2.00	Numberboard (blackw/frostednumbers)(front)(3.7x9.4x0.3mm) (Bangor&Aroostook)(#50)	FG-2100395	2.00
Handrail(maroon)(end) (9.2mmlong) (Boston&Maine)(#1550)(#1551)(#1553)	FC-2101304	2.00	Numberboard (blackw/frostednumbers)(front)(3.7x9.4x0.3mm) (Bangor&Aroostook)(#52)	FG-2100396	2.00
Handrail(yellow)(end) (9.2mmlong) (Boston&Maine)(#1550)(#1551)(#1553)	FC-2101305	2.00	Numberboard (blackw/frostednumbers)(front)(3.7x9.4x0.3mm) (Bangor&Aroostook)(#55)	FG-2100397	2.00
3.) Lens(clear) (3.2x5.7x3.5mm)(2.2x7.0mmlenshead) (ribbedforpressfit)(headlight/reverselight)	FA-0000109	2.00	Numberboard (blackw/frostednumbers)(front)(3.7x9.4x0.3mm) (Boston&Maine)(#1550)	FG-2100398	2.00
4.) Numberboard (blackw/frostednumbers)(front)(2.8x8.2x0.3mm) (RockIsland)(#425)	FG-2100377	2.00	Numberboard (blackw/frostednumbers)(front)(3.7x9.4x0.3mm) (Boston&Maine)(#1551)	FG-2100399	2.00
Numberboard (blackw/frostednumbers)(front)(2.8x8.2x0.3mm) (RockIsland)(#426)	FG-2100378	2.00	Numberboard (blackw/frostednumbers)(front)(3.7x9.4x0.3mm) (Boston&Maine)(#1553)	FG-2100400	2.00
Numberboard (blackw/frostednumbers)(front)(2.8x8.2x0.3mm) (RockIsland)(#428)	FG-2100379	2.00	6.) Liftring(black) (RockIsland)(#425)(#426)(#428) (Boston&Maine)(#1550)(#1551)(#1553)	FC-2100189	0.50
Numberboard (blackw/frostednumbers)(front)(2.8x8.2x0.3mm) (C&O)(#80)	FG-2100380	2.00	Liftring(blue) (C&O)(#80)(#82)(#83) (Bangor&Aroostook)(#50)(#52)(#55)	FC-2101306	0.50
Numberboard (blackw/frostednumbers)(front)(2.8x8.2x0.3mm) (C&O)(#82)	FG-2100381	2.00	7.) Pin(black)(forfan) (1.0x4.5mm)(0.8x3.5mmflathead) (1.4x3.0mmshank)(pinonendhasribsforpressfit)	FC-2100528	1.00
Numberboard (blackw/frostednumbers)(front)(2.8x8.2x0.3mm) (C&O)(#83)	FG-2100382	2.00	8.) Fan(lightgray) (16.0mmdiameter)(10blades)	FC-2100225	2.00
Numberboard (blackw/frostednumbers)(front)(2.8x8.2x0.3mm) (Bangor&Aroostook)(#50)	FG-2100383	2.00	9.) Fan shroud(black) (RockIsland)(#425)(#426)(#428) (Boston&Maine)(#1550)(#1551)(#1553)	FC-2101270	3.00
Numberboard (blackw/frostednumbers)(front)(2.8x8.2x0.3mm) (Bangor&Aroostook)(#52)	FG-2100384	2.00	Fan shroud(blue) (C&O)(#80)(#82)(#83) (Bangor&Aroostook)(#50)(#52)(#55)	FC-2101307	3.00
Numberboard (blackw/frostednumbers)(front)(2.8x8.2x0.3mm) (Bangor&Aroostook)(#55)	FG-2100385	2.00	10.) Vent ( black) (metalscreen)(14.3x28.0mm) (RockIsland)(#425)(#426)(#428)	FC-2101308	4.00
Numberboard (blackw/frostednumbers)(front)(2.8x8.2x0.3mm) (Boston&Maine)(#1550)	FG-2100386	2.00			
Numberboard (blackw/frostednumbers)(front)(2.8x8.2x0.3mm) (Boston&Maine)(#1551)	FG-2100387	2.00			

\*Requires Exchange  
Allpartsarepricedaseach



# BL-2 Diesel Engine

## Shell Parts

Name and Number	Part #	\$Price Per Unit	Name and Number	Part #	\$Price Per Unit
10.) Vent (blue) (metalscreen)(14.3x28.0mm) (C & O)(#80)(#82)(#83) (Bangor&Aroostook)(#50)(#52)(#55) Vent(maroon) (metalscreen)(14.3x28.0mm) (Boston&Maine)(#1550)(#1551)(#1553)	FC-2101309	4.00	21.) Handrail(black,orange) (front&rear)(RockIsland)(#425)(#426)(#428) Handrail(blue) (front&rear)(C&O)(#80)(#82)(#83) Handrail(yellow) (front&rear) (Bangor&Aroostook)(#50)(#52)(#55) Handrail(yellow,black) (front&rear) (Boston&Maine)(#1550)(#1551)(#1553)	FC-2150062 FC-2150063 FC-2150064 FC-2150065	12.00 12.00 12.00 12.00
11.) Lens(clear) (2.5x12.0x30.0x0.3mm)(rearwindow)	FA-0000110	1.00	22.) Screw (M3x16.0mm)(washerhead)(self-drilling)	IA-0000025	0.15
12.) Lens(clear) (19.3x23.0x19.7x0.3mm)(rearsidewindow)	FA-0000111	1.00	23.) L.E.D.s(green)(6v)(2) (80.0mmlongwiresw/yellowmale2pinplug)	CC-0000055	5.00
13.) Lens(clear) (9.0x12.8x0.3mm)(doorwindow)	FA-0000112	1.00	24.) L.E.D.s(red)(6v)(2) (80.0mmlongwires w/yellowmale2pinplug)	CC-0000056	5.00
14.) Lens(clear) (7.0x12.0x19.6x0.3mm)(frontsidewindow)	FA-0000113	1.00	25.) Contactspringbase(black) (plastic)(for1male2pinplug)	BH-0000001	2.00
15.) Handrail(black) (45.0mmlong)(door) (RockIsland)(#425)(#426)(#428) Handrail(blue) (45.0mmlong)(door)(C&O)(#80)(#82)(#83) Handrail(yellow) (45.0mmlong)(door) (Bangor&Aroostook)(#50)(#52)(#55) Handrail(maroon) (45.0mmlong)(door) (Boston&Maine)(#1550)(#1551)(#1553)	FC-2101311 FC-2101312 FC-2101313 FC-2101314	2.00 2.00 2.00 2.00	26.) Contactspring 27.) Screw (4/40x3.0mm)(roundhead) 28.) Engineer(blackman) Engineer(whiteman) 29.) Fireman/Brakeman/Conductor (whiteman) Fireman/Brakeman/Conductor (blackman)	IE-0000015 IA-0000275 FI-0000030 FI-0000001 FI-0000009 FI-0000033	0.50 0.15 5.00 5.00 5.00 5.00
16.) Airhorn(black) (singlechime)(13.9mmlong) (RockIsland)(#425)(#426)(#428) (Boston&Maine)(#1550)(#1551)(#1553) Airhorn(blue) (singlechime)(13.9mmlong) (C & O)(#80)(#82)(#83) (Bangor&Aroostook)(#50)(#52)(#55)	FC-2101273	3.00	30.) Bracket(black) (metal)(formountingengineer&brakeman) 31.) Grommet(black) (cupped)(rubber) 32.) Bracket(black)(metal) (8.0x12.0x7.8mm)(formountinginteriorlights) 33.) Screw (M3x6.0mm)(roundhead) 34.) Bulbs(clear)(6v)(2) (80.0mmlongredwiresw/bluemale2pinplug)	IH-0000357 IH-0000144 IH-0000358 IA-0000016 CG-0000054	4.00 0.50 2.00 0.15 4.00
17.) Shell (black,red,white,silver) (RockIsland)(#425) Shell(black,red,white,silver) (RockIsland)(#426) Shell(black,red,white,silver) (RockIsland)(#428) Shell(blue,yellow,silver) (C & O)(#80) Shell(blue,yellow,silver) (C & O)(#82) Shell(blue,yellow,silver) (C & O)(#83) Shell(blue,yellow) (Bangor&Aroostook)(#50) Shell(blue,yellow) (Bangor&Aroostook)(#52) Shell(blue,yellow) (Bangor&Aroostook)(#55) Shell(maroon,yellow,black) (Boston&Maine)(#1550) Shell(maroon,yellow,black) (Boston&Maine)(#1551) Shell(maroon,yellow,black) (Boston&Maine)(#1553)	FC-2101316 FC-2101317 FC-2101318 FC-2101319 FC-2101320 FC-2101321 FC-2101322 FC-2101323 FC-2101324 FC-2101325 FC-2101326 FC-2101327	*120.00 *120.00	35.) Motorcover(gray) (madeforBL-2only) 36.) Smokeunitfunnel(black) (plastic)(32.0x16.0x58.4x13.3mm) (2mountingtabs)(2stacks)(2parts) 37.) Screw (M3x8.0mm)(roundhead)(self-drillingthreads) 38.) Smokeunit (Proto-Sound®2.0)(10.0x12.0x3.8x5.0mmbrasscup) (26.0mmlongmountingposts) 39.) Screw (M3x3.0mm)(roundhead) 40.) Bracket(black)(metal) (10.0x47.0mm)(10.0mmstep)(mountssmokeunit) 41.) Screw (4/40x6.0mm)(roundhead)	BI-0000069 AA-0000060 IA-0000072 AA-0000059 IA-0000296 IH-0000359 IA-0000003	7.00 6.00 0.15 50.00 0.15 3.00 0.15
18.) Builder'splate(black,brass) (EMD)(2.5x9.8mm)	FC-2101290	3.00			
19.) Lens(clear) (14.0x60.0x0.3mm)(windshield)	FA-0000114	1.00			
20.) Windshieldwipers(black)	FC-2100458	1.00			

\*Requires Exchange  
Allpartsarepricedaseach



# BL-2 Diesel Engine Shell Parts

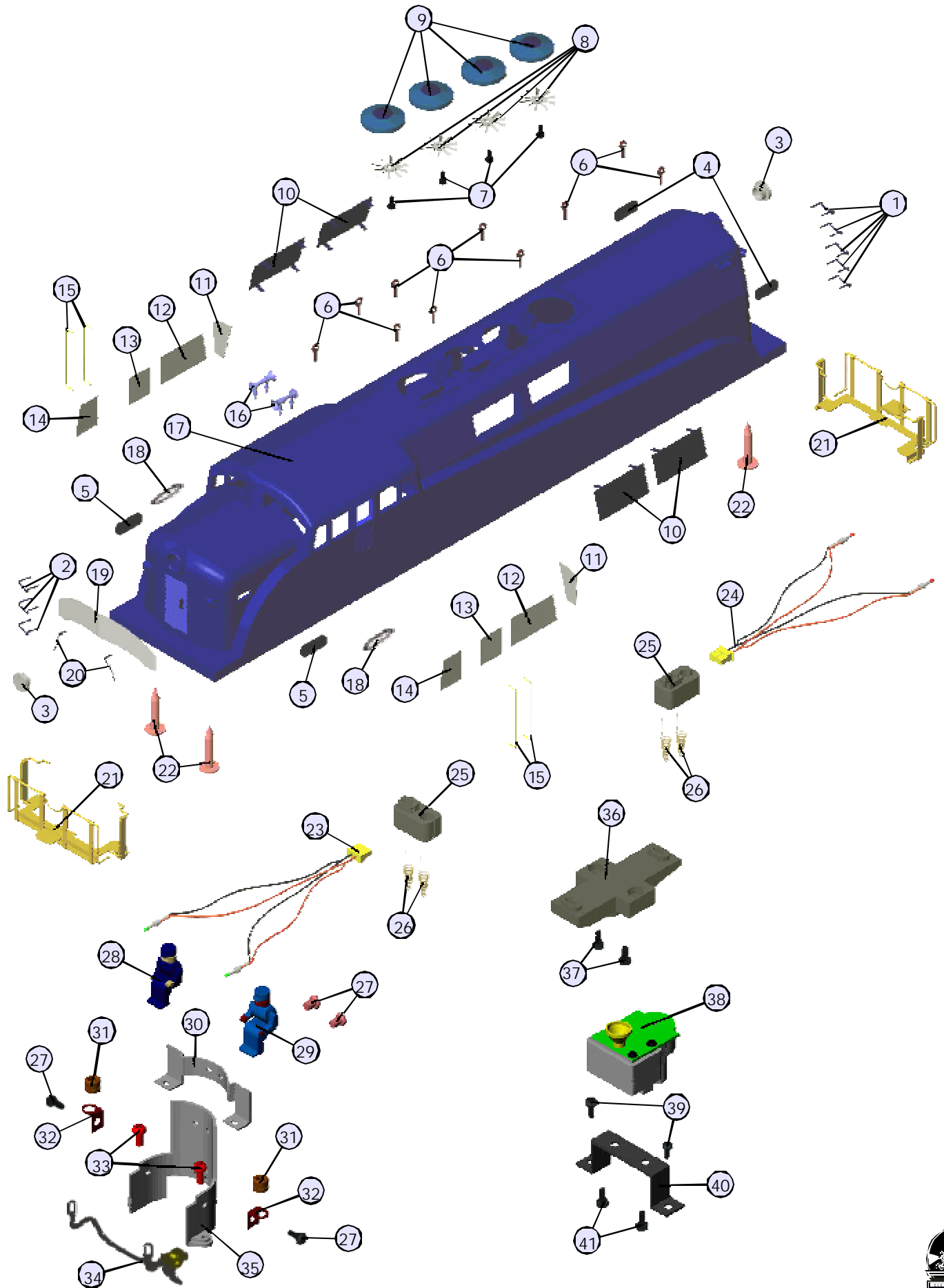



# BL-2 Diesel Engine

## Chassis Parts

NameandNumber	Part #	\$Price PerUnit	NameandNumber	Part #	\$Price PerUnit
1.) Grommet(black) (cupped)(rubber)	IH-0000144	0.50	29.) Insulator(clear) (13.0x19.0x0.1mm)(singlehole)	ID-0000024	0.15
2.) Screw (M3x3.0mm)(roundhead)	IA-0000296	0.15	30.) Board cover(black) (plastic)(34.3x50.0x18.5mm)	BI-0000070	4.00
3.) Bracket(black) (metal)(59.3mmhigh)(hasclipformagneticdoor) (holds1reverselightbulb&2numberboardlightbulb)	IH-0000360	5.00	31.) Boards(Proto-Sound®2.0) (w/Rommemory)(5vboard)	AE-0000001	*200.00
4.) Bracket(black) (metal)(44.5mmhigh)(hasclipformagneticdoor) ( holds1headlightbulb&2numberboardlightbulbs)	IH-0000361	5.00	32.) Screw (M3x4.0mm)(roundhead)	IA-0000010	0.15
5.) Screw (M3x8.0mm)(roundhead)	IA-0000035	0.15	33.) Bracket(Aluminum) (forProto-Sound®2.0boards)(tappedfor6/32screw) (15.0x37.0mm)(16.5mmstep)	IH-0000362	4.00
6.) Spacer(black) (3.0x6.0x4.3mm)(plastic)	ID-0000071	0.15	34.) Wirenut(yellow)	BI-4500003	0.25
7.) Patchboard(green) (20.3x27.3mm) (blue,black&redfemale2pinplugs)	AG-0000068	8.00	35.) Chassis(black) (57.0x335.0mm)(hasholesforbatterychargerjack)	DH-2100042	*20.00
8.) Contactspringboard (greenw/2silverpads)(8.0x12.2x25.5mm)	BH-0000067	3.00	36.) Snowplow(black) (RockIsland)(#425)(#426)(#428) (Boston&Maine)(#1550)(#1551)(#1553)	FH-2130001	4.00
9.) Contactspringboard (greenw/2silverpads)(12.0x17.0x8.7x17.0mm)	BH-0000068	3.00	Snowplow(yellow) (C&O)(#80)(#82)(#83)	FH-2130021	4.00
10.) Bulbs(clear)(6v)(2) (110.0mmlongwiresw/redmale2pinplug) (grainofwheat)(numberboardlights)	CC-0000057	4.00	Snowplow(silver) (Bangor&Aroostook)(#50)(#52)(#55)	FH-2130012	4.00
11.) Bulb(clear)(6v)(1) (85.0mmlongwiresw/bluemale2pinplug) (grainofwheat)(headlight/reverselightbulb)	CA-0000064	4.00	37.) Screw (4/40x6.0mm)(flathead)	IA-0000038	0.15
12.) Tachboard(green)(standard)	AG-0000033	6.00	38.) Pilot(black) (pilothas2screwholesformounting)(complete) (RockIsland)(#425)(#426)(#428) (Boston&Maine)(#1550)(#1551)(#1553)	DG-2150055	20.00
13.) Rubberband	BI-4500004	0.50	Pilot(yellow) (pilothas2screwholesformounting)(complete)	DG-2150056	20.00
14.) Motor(RS-365SH) (7.9x17.0mmlongwormgear)(10.5mmlongthreads) (9.0x30.0mmwhiteflywheelw/blackstripes) (w/blackplastictachboardbracket)	BE-0000126	25.00	(C&O)(#80)(#82)(#83)	DG-2150057	20.00
15.) Motor(RS-365SH) (7.9x17.0mmlongwormgear)(10.5mmlongthreads) (5.0x30.0mmblacktaperedflywheel)	BE-0000127	25.00	Pilot(silver) (pilothas2screwholesformounting)(complete) (Bangor&Aroostook)(#50)(#52)(#55)	DG-2150057	20.00
16.) Motormount(black)	BI-0000009	15.00	39.) T-bar ( black) (4.0x20.0mm)(plastic)	IG-0000001	0.50
17.) Screw(yellowZink) (M2.5x6.0mm)(roundhead)(w/lockwasher)	IA-0000001	0.15	40.) Proto-Coupler®(black) (Proto-Coupler®2.0)(51.0mmlong)	DD-0000032	10.00
18.) Screw (M3x14.0mm)(roundhead)(w/lockwasher)	IA-0000012	0.15	41.) Airhoses(black)(3lines)	FC-2100711	3.00
19.) Screw (M2x4.0mm)(roundhead)	IA-0000058	0.15	42.) Spring(nickel) (6.5x14.0mm)(w/0.5mmthickwire)	IE-0000005	0.50
20.) Switch(large)(2position)	BB-0000006	5.00	43.) Washer (4.5x10.0x0.5mm)(metal)	ID-0000009	0.15
21.) Batteryleads (140.0mmlongwiresw/smallblackmale2pinplug) (175.0mmlongwiresw/batterychargerjack)	BC-0000171	6.00	44.) E-clip (3.0x8.0x0.5mm)(metal)	IF-0000002	0.15
22.) Battery(white) (8.4volts)(re-chargable)(nickel-cadium)	BG-4000001	10.00	45.) Wirestrap(black) (metal)(small)	IH-0000012	1.00
23.) Bracket(black) (battery)(verticalmount)(plastic)	IH-0000042	4.00	46.) Screw (4/40x6.0mm)(roundhead)	IA-0000003	0.15
24.) Screw (6/32x12.0mm)(roundhead)	IA-0000103	0.15	47.) Screw(nickel) (M3x6.0mm)( roundhead)	IA-0000015	0.15
25.) Screw (M3x6.0mm)(roundhead)	IA-0000016	0.15	48.) Insulator(black) (top)(square)(pick-up)	BD-0000015	2.00
26.) Speakercone(black) (34.0x37.8x11.0mm)(plastic)(2screwwholetabs) (shavedon2sides)	BF-0000025	4.00	49.) Truckside(silver) ( fits2axlescaletruck) (truckside screwsmountfrombottom) (2-4/40threadedholesontopformountingladders) (RockIsland)(#425)(#426)(#428) (Bangor&Aroostook)(#50)(#52)(#55)	DB-2150006	7.00
27.) Insulator(white) (washer)(3.0x6.0x3.0mm)(plastic)	ID-0000025	0.15			
28.) Voltagereregulator (LM2937ET)	AG-0000032	3.00			

\*RequiresExchange  
Allpartsarepricedaseach



# BL-2 Diesel Engine

## Chassis Parts

NameandNumber	Part #	\$Price PerUnit	NameandNumber	Part #	\$Price PerUnit
49.) Truckside(black) (fits2axlescaletruck) (trucksidescrawmountfrombottom) (2-4/40threadedholesontopformountingladders) (C&O)(#80)(#82)(#83) (Boston&Maine)(#1550)(#1551)(#1553)	DB-2150007	7.00	NS.) Wireharness(forsmokeunit) (blackmale4pinplug) (160.0mmlongbrown,purple,green&graywires)	BC-0000167	4.00
50.) Volumepot (smallvolumepot)(bluew/greenboard)	BI-0000040	5.00	NS.) Wireharness(formotors) (blackmale5pinplug) (150.0mm&130.0mmlongyellow&whitewires)	BC-2200032	4.00
51.) Screw (4/40x3.0mm)(roundhead)	IA-0000275	0.15	NS.) Wireharness (blackmale7pinplug) (255.0mmlongwiresw/standardtachboard) (105.0mmlongblack&redwires)	BC-0000172	10.00
52.) Ladder(silver) (right)(mountstofronttruck) (RockIsland)(#425)(#426)(#428) (Bangor&Aroostook)(#50)(#52)(#55)	FC-2101328	4.00	NS.) Wireharness (blackmale12pinplug)	BC-2100040	25.00
Ladder(black) (right)(mountstofronttruck) (C&O)(#80)(#82)(#83) (Boston&Maine)(#1550)(#1551)(#1553)	FC-2101329	4.00			
53.) Ladder(silver) (left)(mountstofronttruck) (RockIsland)(#425)(#426)(#428) (Bangor&Aroostook)(#50)(#52)(#55)	FC-2101330	4.00			
Ladder(black) (left)(mountstofronttruck) (C&O)(#80)(#82)(#83) (Boston&Maine)(#1550)(#1551)(#1553)	FC-2101331	4.00			
54.) Tractiontire(black) (rubber)(4.0x17.0mm)	DE-0000018	0.75			
55.) Speaker(STAR) (FR-050-A1421)(16ohms)(5W)(50.0mmspeaker)	BF-0000022	10.00			
56.) Bracket(brass) (speaker)(12.0x9.7mm)(5.0mmstep) (roundedendbymountinghole)	IH-0000322	1.00			
57.) Gasket (black)(speaker)(foam) (46.0x51.0mm)(4.5mmthick)(for50.0mmspeakers)	IB-0000011	1.00			
58.) Truck(black) (powered)(2axle)(trucksidemountfrombottom) (2screwholesfor2screwmountpilot)	DA-2050010	*30.00			
59.) Nut(nickel) (2.5x5.0x10.0mm)(formountingpick-up)	IC-0000005	0.50			
60.) Insulator(black) (pick-up)(bottom)(flatw/rect.box)(18.0x30.0mm)	BD-0000039	2.00			
61.) Pick-up (8.0x11.0mmroller)(28.0mmlong)	BD-0000025	5.00			
62.) Fuel tank (blackw/silvermarkings) (RockIsland)(#425)(#426)(#428) (Boston&Maine)(#1550)(#1551)(#1553)	FC-2101332	*20.00			
Fuel tank (silver,blackw/redmarkings) (C&O)(#80)(#82)(#83)	FC-2101333	*20.00			
Fuel tank (blue,silverw/redmarkings) (Bangor&Aroostook)(#50)(#52)(#55)	FC-2101334	*20.00			
63.) Batterychargerjack(complete)	BG-0000001	3.00			
NS.) Wireharness(forspeaker) (70.0mmlongwiresw/whitemale2pinplug)	BC-2100027	3.00			
NS.) Wireharness (90.0mmlongwiresw/blackmale2pinplug) (blackwireshieldonwires)(forProto-Coupler®)	BC-1100008	4.00			
NS.) Wireharness (180.0mmlongred&blackwiresw/eyelets) (black wireshieldonwires)(powersupplyfrompick-ups)	BC-2100020	4.00			

\*RequiresExchange  
Allpartsarepricedaseach



# BL-2 Diesel Engine Chassis Parts

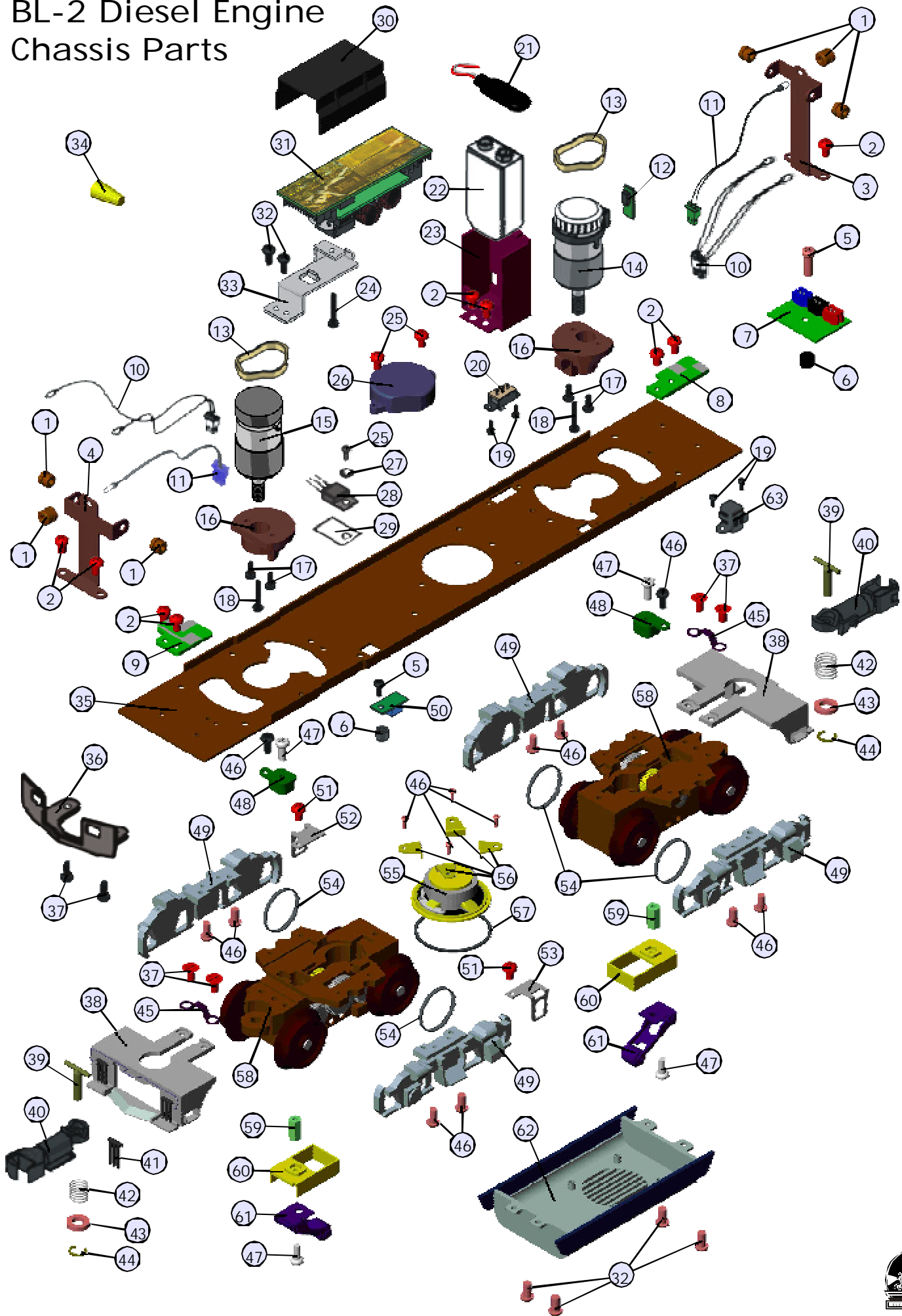

# Smoke Unit Proto-Sound® 2.0

## Smoke Unit Parts

Name and Number	Part #	\$Price Per Unit
1.) Screw (4/40x6.0mm)(roundhead)	IA-0000003	0.15
2.) Gasket(burntorange) (forstandardsmokeunit)(25.0x37.0mm)(0.5mmthick)	IB-0000006	2.00
3.) Screw (M1.4x3.0mm)(roundhead)	IA-0000120	0.15
4.) Fan impeller(black) (plastic)(forsmokeunit)	AI-0000019	2.00
5.) Heating elements (forsmokeunit)	AI-0000018	
6.) Wick (white) (forsmokeunit)(4"long)(soldasapair) (requires2wickspersmokeunit)	AA-0000001	1.00
7.) Motor (forsmokeunit)(wireharnessnotincluded)	BE-0000041	5.00

All parts are priced as each

